

# FLEMISH BOND

## S Q U A R E   S T O P P E D   E N D S

### DOUBLE FLEMISH

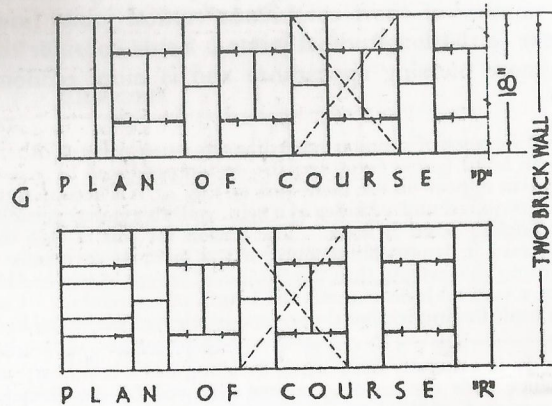
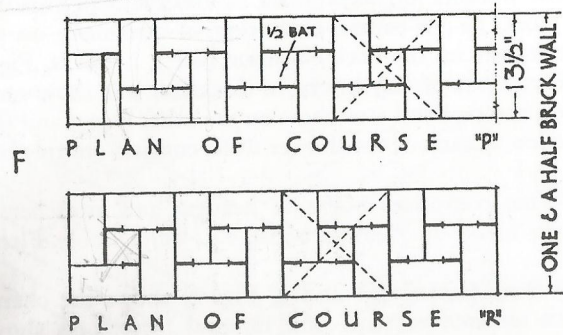
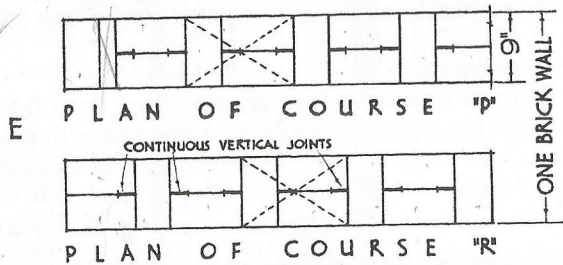

THE ABOVE ARE ALTERNATIVE DETAILS OF THE STOPPED END OF THE DOORWAY OPENING "C" AT "A", FIG. 3.

### SINGLE FLEMISH

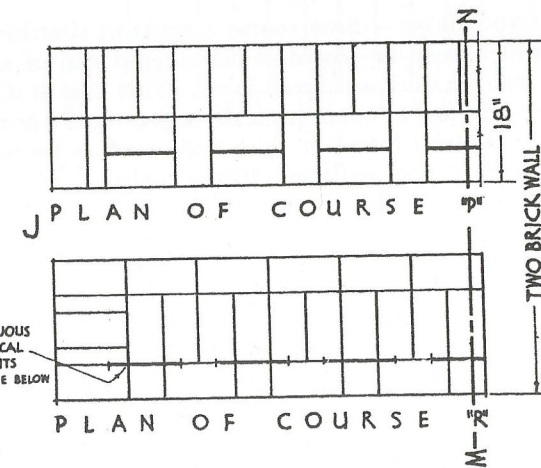
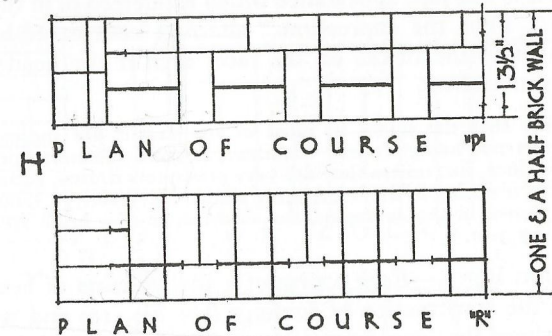
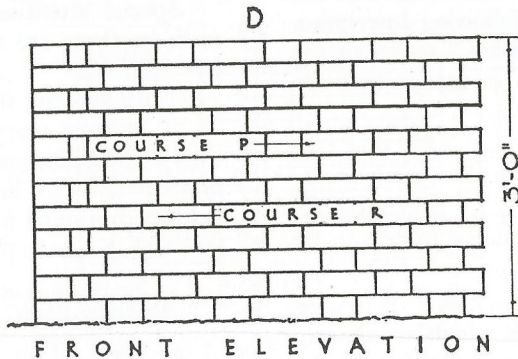

### ALTERNATIVE BONDING TO COURSE "R" AT "J"

NOTE REDUCTION IN WIDTH OF CONTINUOUS VERTICAL JOINTS

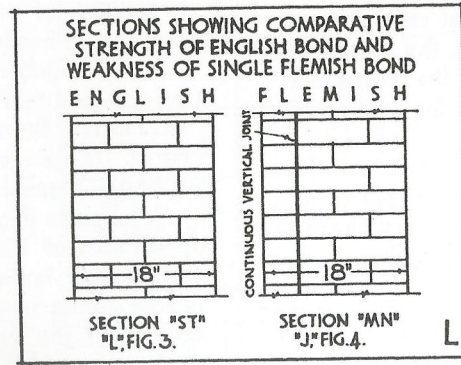
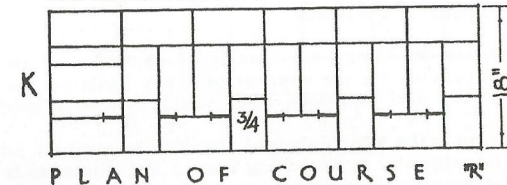

#### NOTE:

1. IN DOUBLE FLEMISH BOND, ALTERNATE HEADERS & STRETCHERS IN EACH COURSE ON BOTH FACES.
2. IN SINGLE FLEMISH BOND, ALTERNATE HEADERS & STRETCHERS IN EACH COURSE ON ONE FACE ONLY WITH A BACKING IN ENGLISH BOND.
3. QUEEN CLOSER ALWAYS ADJOINS THE QUOIN HEADER.
4. EACH HEADER IS CENTRALLY OVER A STRETCHER.
5. CONTINUOUS VERTICAL JOINTS SHOWN BY THICK LINES.
6. FORMATION OF UNITS WITHIN BROKEN DIAGONAL LINES. --
7. VERTICAL PERPENDS.

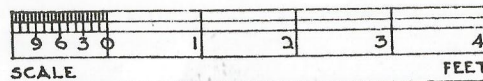

FIGURE 4