

TYPES OF STAIRCASES

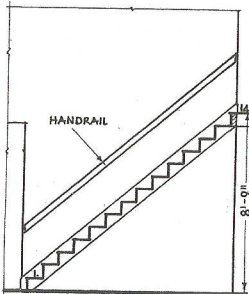

SECTION "P P"

A

PLANS

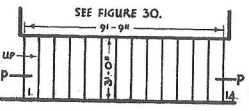

STRAIGHT FLIGHT

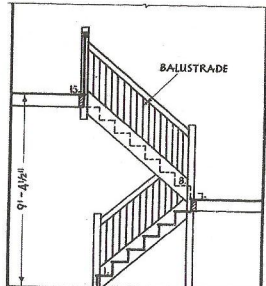

SECTION "Q Q"

B

SEE FIGURES 32, 33 & 35.

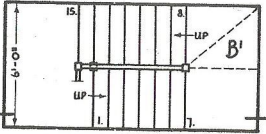

DOG-LEG

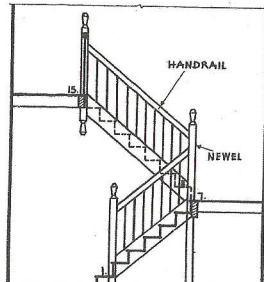

SECTION "R R"

C

SEE FIGURES 36 & 37.

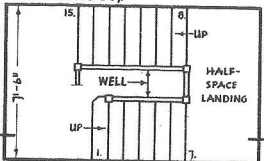

OPEN WELL

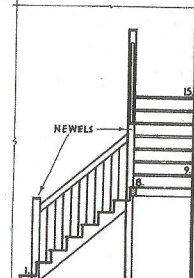

SECTION "S S"

D

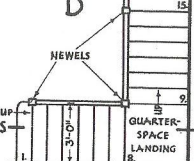

NEWEL QUARTER-TURN STAIRS

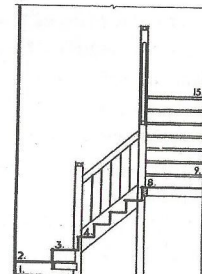

SECTION "T T"

E

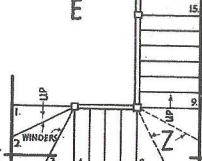

NEWEL QUARTER-TURN STAIRS

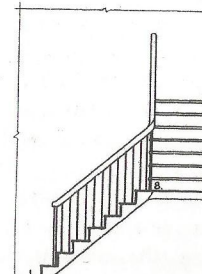

SECTION "U U"

F

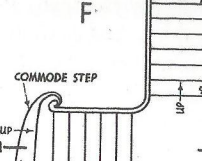

GEOMETRICAL

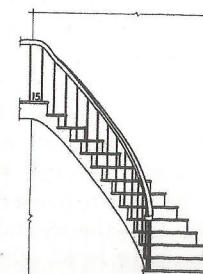

ELEVATION

G

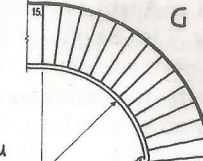

GEOMETRICAL

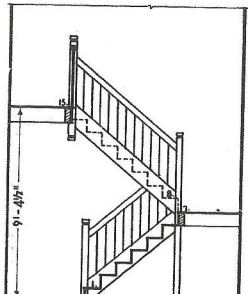

SECTION "V V"

H

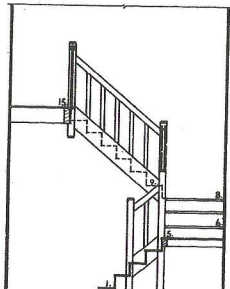

SECTION "W W"

J

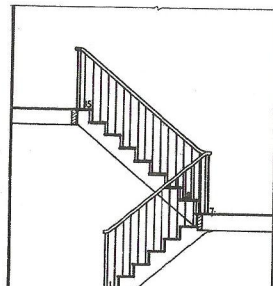

SECTION "X X"

K

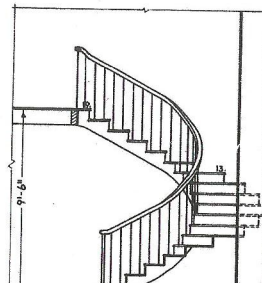

SECTION "Y Y"

L

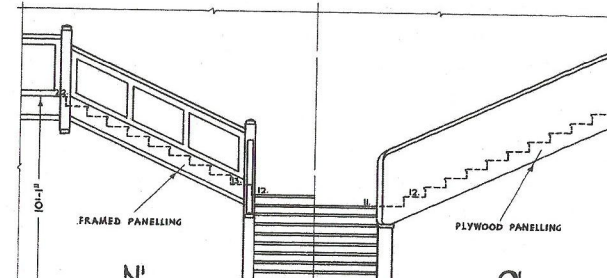

N

O

ELEVATION

M

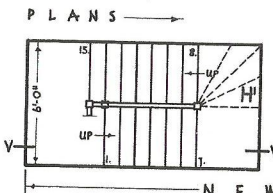

NEWEL HALF-TURN STAIRS

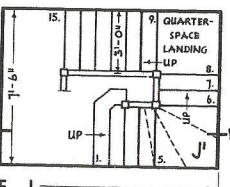

NEWEL HALF-TURN STAIRS

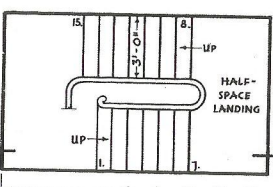

NEWEL HALF-TURN STAIRS

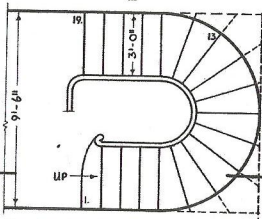

NEWEL HALF-TURN STAIRS

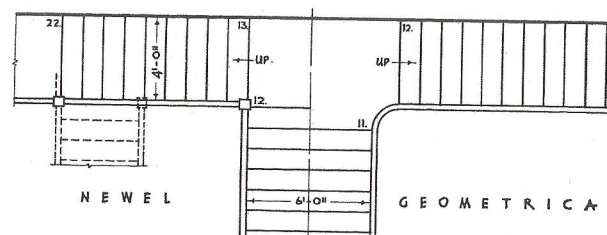

NEWEL

GEOMETRICAL

N

O

BIFURCATED STAIR

FIGURE 29

NOTE: THE PROPORTIONS OF THE STEPS OF THESE STAIRS COMPLY WITH THE RULE "GOING PLUS TWICE RISE EQUALS 23" TO 24". THUS, THE GOING & RISE OF THE STEPS ARE 11" & 6" AT "L", 12" & 5 1/2" AT "M" AND 9" & 7 1/2" AT THE REMAINDER.

