

AQUAPANEL®

Q4 Finish

Full-surface ready-to-use skim coat for smooth high quality finish



The AQUAPANEL® Q4 Finish from Knauf USG Systems is an innovative filler and water-repellent skim coat that can produce a fine finished surface up to Q4 standard when used as a coating on AQUAPANEL® Cement Board Indoor. No reinforcing is required for wall applications. For contractors and installers, it offers a new, faster full surface treatment as an ideal base for smooth, glossy or finely textured wall coverings.

Application

When used as a coating on AQUAPANEL® Cement Board Indoor, AQUAPANEL® Q4 Finish guarantees a flat, smooth, high quality finish for walls. No reinforcing is required. It can also be used as a surface finish for ceiling applications and impact resistant walls, when used on top of AQUAPANEL® Joint Filler and Skim Coating – white with AQUAPANEL® Reinforcing Mesh.

AQUAPANEL® Q4 Finish can be applied in humid areas but is not suitable for areas subjected to water spray.

Base / Pre-treatment

AQUAPANEL® Cement Board Indoor must be fixed firmly onto a structurally supporting framework according to installation guidelines. The surface must be dry, clean and dustfree. The subsurface is primed with AQUAPANEL® Interior Primer.

Handling & installation

Stir AQUAPANEL® Q4 Finish well. If required, thin with a small amount of water. Use clean mixing containers and tools (stainless steel smoothing float).

AQUAPANEL® Q4 Finish is used without reinforcing mesh as a skim coat on walls. The maximum coating depth is 2 mm per application.

First, fill all screw heads and board joints -which have already been glued with AQUAPANEL® Joint Adhesive (PU) - with AQUAPANEL® Q4 Finish. Embed cover strips in the joints (for example Knauf glass fibre joint cover strips).

Sand away any irregularities and apply a second coat of AQUAPANEL® Q4 Finish (at least 20 cm wide), re-embedding the screw heads. Once this has dried, sand away any unevenness.

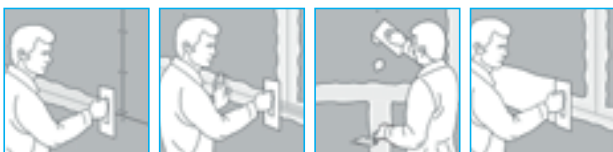

For full-surface skim-coating, apply AQUAPANEL® Q4 Finish evenly with a float approximately 20 cm wide (coating depth at least 1 mm). Then fill in any uneven areas in the joints and smooth the surface structure (if necessary, sand after drying).

Subsequently apply a wider coating of AQUAPANEL® Q4 Finish (coating depth approx. 0.5 mm) and, when dry, finish with abrasive paper (grade 120 or finer). The drying time is approximately 24 hrs per mm of coating thickness, depending on the temperature and humidity.

AQUAPANEL® Q4 Finish can also be applied as a finish on AQUAPANEL® Joint Filler and Skim Coating - white. This finishing style can be used on walls as well as on ceilings.

For application of AQUAPANEL® Q4 Finish by machine, we recommend the Knauf PFT Samba XL.



Surface treatment

AQUAPANEL® Q4 Finish can be painted over with water emulsion paints, acrylic paints, water emulsion silicate colours and lime colours.

Specifications

Colour	white
Specific weight	1.6 g/cm ³
Open time	> 25 minutes (at 23°C and 63% rel. humidity)
Drying time	approx. 24 hrs (at 23°C and 63% rel. humidity)
Max. grain size	50 µm
Viscosity	29-31 Pa·s

Material coverage

Approx. 1.7 kg/m²/mm coating depth

Working time

Manual application: approx. 7 – 11 minutes (depending on surface quality)

Working temperature / climate

Skim coating should only be done once the AQUAPANEL® Cement Board Indoor panels have acclimatised to the ambient climatic conditions. The material, ambient and background temperature must not fall below +5°C.

Method of delivery / storage

- 20 kg/pail
- Store in dry, cool and frost-free conditions
- Unopened storage life approx. 12 months

Item code 82637