

## Heradesign® style

3-layer, magnesite bonded wood wool decorative panel with HPL coating on both sides (Micro-perforation: 5/5-1.3 mm). Closed surface with top acoustic absorption values.

### Product Description Code

**WW-EN 13168-L3-W2-T2-S3-P2-CS(10-Y) 20-TR5-CI3**

### Special Product Features

- 3-layer, acoustically effective decorative product
- wood wool absorber core coated on both sides
- by default, the edge is designed with the decorative coating and colour
- coating = HPL (High Pressure Laminate)
- panel has only one exposed side – the back is designed as blind HPL
- coating is perforated

### Scope of Applications

- for covering wall and ceiling surfaces in commercially available, standardised, installation systems for acoustically effective and decorative purposes; installation recommendations and standard edge designs can be requested at [www.heradesign.at](http://www.heradesign.at).

### Sizes (standard)

- 600 x 600, 1200 x 600 mm (pre-cut or fitting pieces possible on request)

### Colours – Surface (standard)

- choice of 72 decorative colours based on the Argolite Uni collection – surface quality matt aluminium

### Perforation

- linear perforation 5/5 – 1.3 mm with 10 mm perforation-free edge on overleaf

---

### **Attention:**

- The HPL decorations from the Argolite collection are colour consistent. If custom colours from RAL or NCS are selected where a paint coating is needed, then minor colour deviations can't be completely excluded in spite of close monitoring of the colour mixing.
  - manufacturing tolerance of nominal dimensions as per product declaration: length  $\pm 1$  mm, width  $\pm 1$  mm, thickness  $\pm 1$  mm
  - maximum dimensional changes in a standard climate of 23°C/50% rel. humidity is  $\pm 1\%$
  - max. span is 600 mm
  - For 3-layer Heradesign decorative panels, it is necessary to not exceed relative air humidity of 35 – 65% at 10 - 35°C when working with the panels (processing conditions). High construction humidity can have negative consequences.
  - not suitable for glue mounting.
-

Delivery form

Thickness	[mm]	25.0
Weight	[kg/m <sup>2</sup> ]	approx. 17.5
<i>m<sup>2</sup>/packaging unit for standard format</i>		
600 x 600 mm	[m <sup>2</sup> ]	18.0
1,200 x 600 mm	[m <sup>2</sup> ]	18.0

Degree of sound absorption  $\alpha_D$

Frequency (Hz)	125	250	500	1000	2000	4000	$\alpha_w$	Absorber KI
<b>Herakustik® style, 25 mm</b>								
1. Dist.: 275mm/Heralan AP-GS 40mm	0.58	0.77	0.85	0.73	0.83	0.63	0.80	B
2. Dist.: 40mm/Heralan AP-GS 40mm	0.23	0.98	0.96	0.70	0.81	0.60	0.80 (L)	B
3. Dist.: 40mm	0.04	0.25	0.76	0.59	0.59	0.56	0.55	D

Additional sound absorption values on request

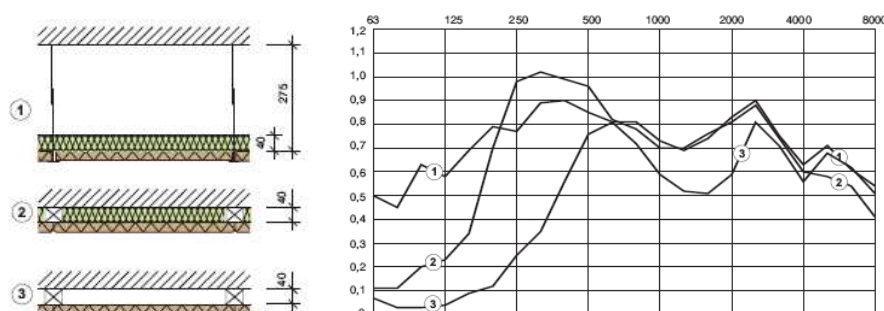

Technical Data – Product Construction

1. Heradesign® Absorber Core

Properties	Symbol	Data	Units	Standard
Reaction to fire	---	A2-s1, d0	[---]	EN 13501-1
Thickness	D	25	[mm]	EN 13168
Nominal value of thermal conductivity	$\lambda_D$	0.095	[W/mK]	EN 12667
Thermal resistance	RD	0.25	[m <sup>2</sup> K/W]	EN 13168
Bending resistance <sup>*)</sup>	$\odot_b$	>2200	[kPa]	EN 12089
Diffusion resistance value	$\mu$	5	[---]	EN 12086

<sup>\*)</sup> As per method A of EN 12089

2. Coating

- laminate standard = HPL (High Pressure Laminate)
- thickness 0.8 mm
- surface quality matt aluminium (satin or high-gloss on request)
- colours according to RAL or NCS are possible
- meets the highest demands regarding resistance to impact, scratching, and abrasion as per EN 438 / ISO 4586
- light-fast and stable colour

**Coating Composition:**

- overlay for imprinted decorations
- decorative paper
- multi-layer craft paper

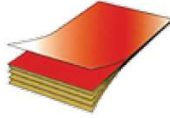

- Alternative flame resistant version available!
- Standard B1 (Germany) and M1 (France)

### 3. Perforation

- Perforation pattern – linear grid

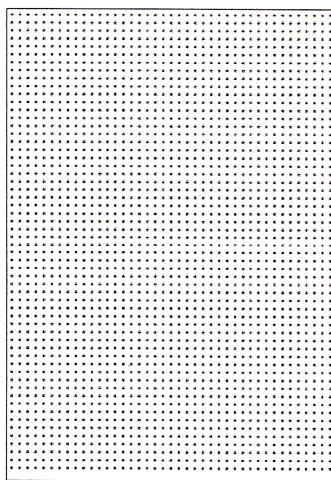

Open space:  
**5.0%**  
Grid/Perforation:  
**5/5 – 1.3**

### Handling and Storage

The installation of Heradesign decorative panels is part of interior decorating and must only be carried out under controlled humidity and temperature conditions. All dust-causing construction measures must be completed before starting the installation. Store panels level to plane and protect against moisture and soiling. The packaging doesn't protect the product against rain!

Therefore, these products must be very specifically protected against moisture at the construction site. Absolute dry storage is mandatory. When sorting or laying out the panels, the supplied protective film must always be used between the panels. In this connection, please also observe the possibility of rising damp in new buildings.

Observe the relevant application, installation, and storage guidelines for Heradesign products.

### Planning Service

Heradesign offers a special CAD planning service for the Heradesign style product. On one hand, this makes exact planning of the ceiling face possible. On the other hand, exact calculation of the order quantity is also possible. With this service, it is also possible to have special fitting pieces produced. You can obtain more detailed information from our technical customer service and at [www.heradesign.at](http://www.heradesign.at).

Distribution is handled via specialised trade.

Heradesign Ceilings Division  
A business unit of Knauf Insulation GmbH  
A – 9702 Ferndorf 29  
Tel: +43/4245-2001 3332  
Fax: +43/4245-2001 3056  
d.klammer@heradesign.at

The product data sheet presented here corresponds to the current state of development of our products and loses its validity when a new issue appears. Always make sure that you are using the latest issue of this information in each case. The suitability of the product is not binding for exceptional isolated cases. The guarantee and liability upon delivery are orientated around our general terms and conditions. No responsibility is assumed for the correctness of this information.

Datenblatt\_Heradesign® style 01.03.2008 (replaces version 01.02.2007)